

LeakAlertor® 6000 User's Guide

Getting Started

Installing Your LeakAlertor – This is *SO* easy!

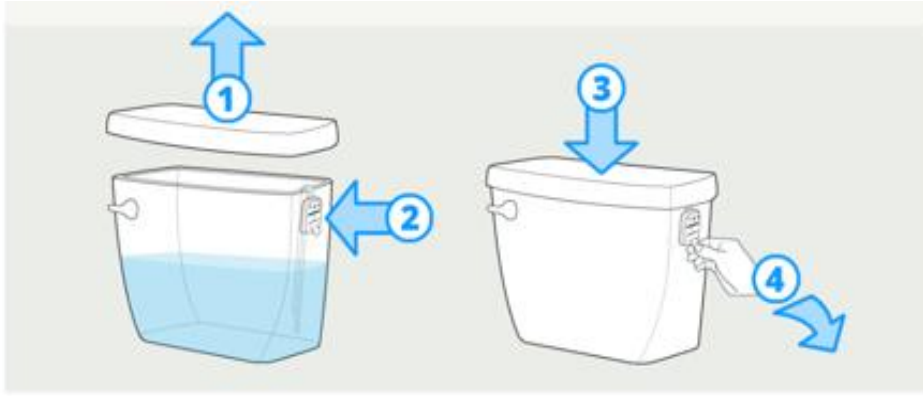

- 1) Remove tank lid.
- 2) Place the LeakAlertor over the edge of the tank.
- 3) Replace tank lid.
- 4) Pull battery tab.
(Lightly press the unit against the tank while pulling the tab straight down to remove.)
- 5) That's It!! You're Done!



I Just Pulled the Battery Tab...Now What Happens? *Relax...*

The LeakAlertor needs about an hour to get to know your toilet. During that time, you'll see the **GREEN** LED "triple flash". Don't worry - you can still use the toilet. Once the LeakAlertor feels at home, all three LEDs will begin to flash at once. Just flush the toilet and the LeakAlertor will go to work.

How do I know if I have a problem with my toilet?

Every time you flush the toilet, watch the LeakAlertor!

What to expect when the toilet is *Flushed*:

ALERTS	FLASHES/BEEPS	DIAGNOSIS	ACTION REQUIRED
	Continuous Flash	No problem!	No action required!
	Continuous Flash	Battery is low and needs to be replaced	Replace with a CR2032 battery.
	2 Flashes + 2 Beeps	Toilet has a leak	A Repair is necessary. Replacing the flapper is recommended.
	2 Flashes + 1 long Beep, followed by 2 short Beeps	Faulty Fill valve	Replace fill valve <i>(Fluidmaster 400 fill valve is recommended)</i>
	Continuous Flashes + Beeps	Flapper is stuck open or toilet is about to overflow	Shut off water to toilet immediately!! (Alert won't stop until the problem is corrected or the reset button is pressed).

LeakAlertor® 6000 User's Guide

Re-Setting the LeakAlertor

(The *RESET* button is recessed inside the enclosure as shown below. You will need to use a small object to press the button such as a toothpick or paperclip)

- 1) **Press and Hold** the *RESET* button. When the **RED** LED illuminates, release the *RESET* button.
- 2) The unit flashes all three LED's one time and beeps. The **GREEN** LED will flash for about a minute, after which the **YELLOW** LED will begin to flash.
- 3) **Flush** the toilet any time after the **YELLOW** LED begins to flash to complete the reset.

You're all done, the unit has been reset!!

Reset the LeakAlertor to:

- Remove the unit temporarily from the toilet.
- Make a repair to the toilet,
- Temporarily silence the alerts,

Testing the LeakAlertor - Easy as 1-2-3

- ❖ During testing and evaluation, it is recommended that the tank lid *not* be put back on the toilet. This allows evaluators to observe the LeakAlertor 6000 responses to the various tests described below.
- ❖ **Do not test the unit for at least two to three minutes after you last flushed the toilet.**



- 1) **Press and Continue to Hold** the *RESET* button. The **RED** LED will turn on, and then the **YELLOW** LED will turn on.
- 2) **Release** the *RESET* button when the **YELLOW** LED turns on.
- 3) **Flush** the toilet and **watch** the LED's during the entire flush cycle*:
 - a) **RED** LED – The water level in the tank is *dropping*
 - b) **GREEN** LED – The water level in the tank is *rising*
 - c) **YELLOW** LED – The water level in the tank is *stable*

The unit will automatically exit the TEST MODE after about three minutes. The unit will flash the **YELLOW** LED during test mode when the water level in the tank is not moving.

*(Note: When the water has reached its lowest level in the tank during the flush, the water turbulence may cause the unit to appear as though the LEDs are flashing randomly for a few seconds. The unit is detecting the rising/falling water height of the turbulence and alerting accordingly. Once the water height begins to steadily rise, the unit will continue to flash the green LED until the water height stabilizes at the end of the flush.)